

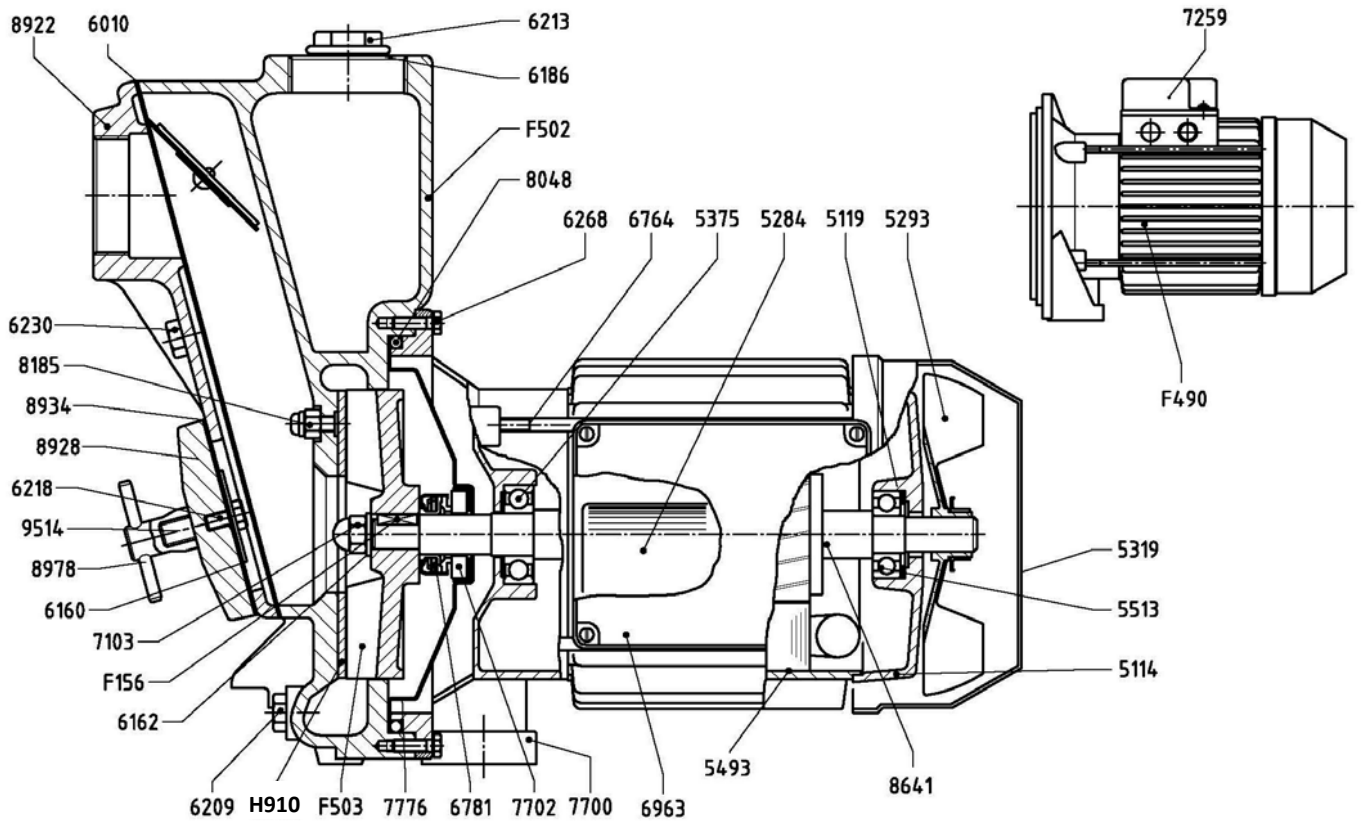

AUSSIE SPARES DIAGRAM & PARTS LIST

AUSSIE GMP PUMPS: B1½KQ-A/ST WITH 1HP ELECTRIC MOTOR
CAT EA6F



| Part Number | Qty | Description | List price |
|-------------|-----|------------------------|------------|
| 6100 | 1 | Check Valve B 2672 | \$24 |
| 6160 | 1 | Washer B 2672/1 | \$5 |
| 6162 | 1 | Washer 8x17x1.5 | \$2 |
| 6168 | 1 | Washer B 2621/2 | \$7 |
| 6186 | 1 | Flex. Washer 33x39x2 | \$2 |
| 6209 | 1 | Conical Tap ¼" Gas | \$6 |
| 6213 | 1 | Conical Tap 1" Gas | \$7 |
| 6230 | 4 | Hex. Head Screw M8x20 | \$5 |
| 6614 | 8 | Screw T.E. M 5x14 | \$1 |
| 6781 | 1 | Mech. Seal 16-32-13 | \$196 |
| 7103 | 1 | Brass Nut M 8x1.5 | \$5 |
| 7702 | 1 | Counterface 17.5-36-8 | \$31 |
| 7776 | 1 | Cover Disk dis. G 1708 | \$31 |
| 7781 | 1 | OR 221 (149.2x5.34) | \$7 |

| Part Number | Qty | Description | List price |
|-------------|-----|------------------------------|------------|
| 8185 | 3 | Torque Nut M5 A2 | \$4 |
| 8922 | 1 | Valve B1½KQ-A/ST | \$172 |
| 8928 | 1 | Inspection Door | \$65 |
| 8934 | 1 | Gasket Inspect. Door | \$12 |
| H910 | 1 | Complete Wear Disc kit | \$65 |
| 8978 | 2 | Complete Pin M8 | \$43 |
| 9325 | 1 | Rivet 6x12 | \$2 |
| 9514 | 2 | Grub Screw M8x50 | \$7 |
| F156 | 1 | Stainless Steel Key B 4x4x16 | \$6 |
| F159 | 3 | Washer | \$6 |
| F490 | 1 | Electric Motor 1HP 230/400V | \$839 |
| F502 | 1 | Pump Casing | \$767 |
| F503 | 1 | Impeller B1½KQ-A/ST | \$259 |