



AUSSIE SPARES DIAGRAM & PARTS LIST

AUSSIE HYDROTEK SS SERIES

SS SERIES DIRECT DRIVE

02-11-09
EFFECTIVE S/N 200900240

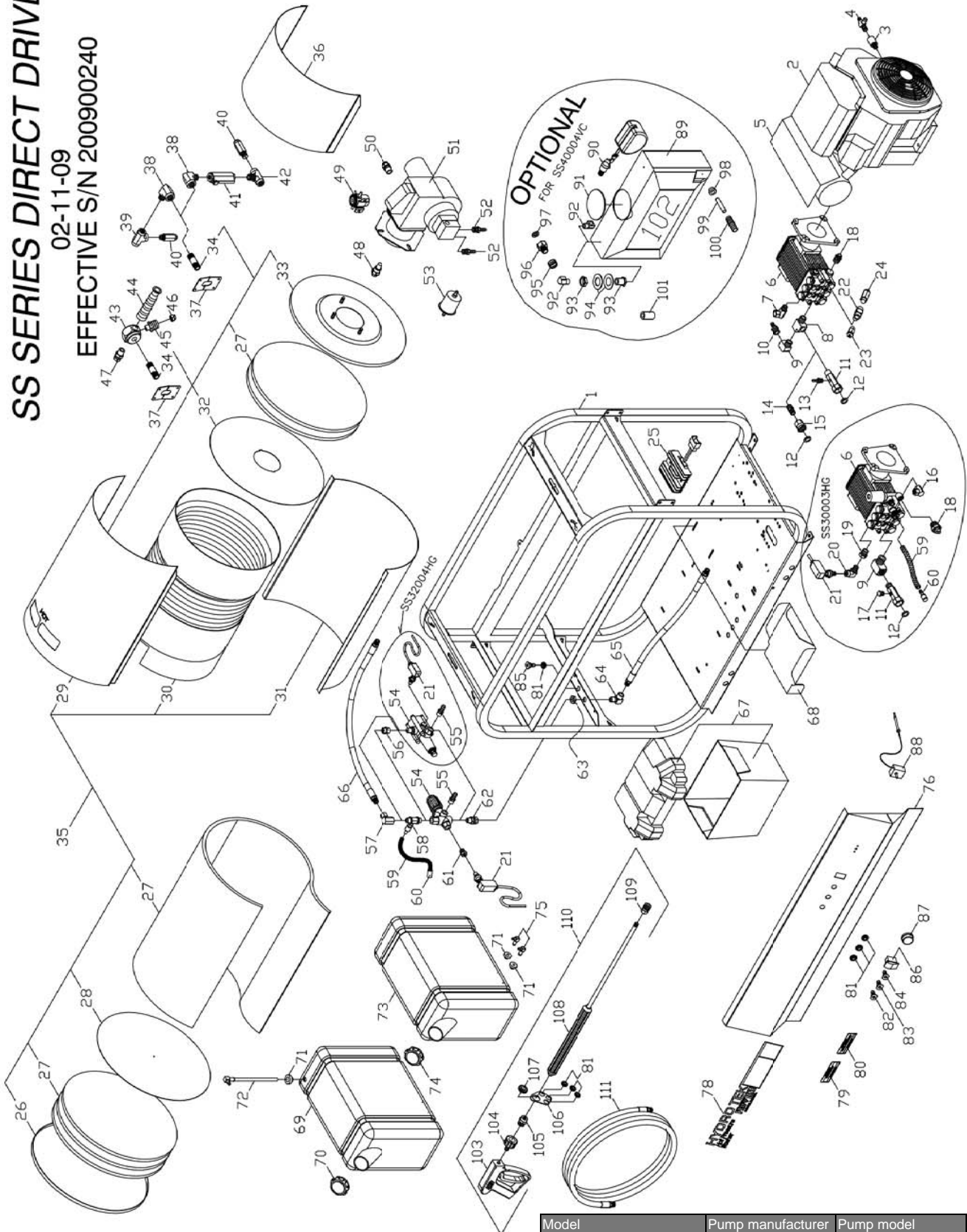

Summary of pumps used by Australian Pump:

Model	Pump manufacturer	Pump model
HSS30005VG	General pump	WS202
HSS32004HB	Bertolini	TMG4040
HSS35003DG	General pump	EZ303634U1
HSS32004HG	General pump	EZ4040G





AUSSIE SPARES DIAGRAM & PARTS LIST

AUSSIE HYDROTEK SS SERIES

1 HSS00	FRAME STACKABLE B/D SS ASSEM	ALL		57 DE766	SWIVEL 3/8F x 90 STEEL (BRAZED)	ALL	
2 MH009	ENGINE 9hp HONDA PULL START	SS30003HG		58 VC037	CHEMICAL INJECTOR ADJ. 4000psi	SS32004HG,SS38004VG,SS40004VC	
MH135	ENGINE 13hp HONDA E/S 18amp***	SS32004HG		59 DHB04	TUBING: CLEAR BRAIDED: 1/4	ALL	
MS145	ENGINE 14hp VANGUARD E/S	SS38004VG		60 VF042	STRAINER CHEM (NO CHECK)	ALL	
MS150	ENGINE GAS 16hp VANGUARD E/S W	SS40004VC		61 DA064	BUSHING 3/8M x 1/4 STEEL	SS38004VG,SS40004VC	
3 MKD13	OIL DRAIN ADAPTER 12mm x 3/8 "	SS30003HG,SS32004HG		62 DE566	SWIVEL 3/8 STEEL	SS32004HG,SS38004VG,SS40004VC	
4 MS006	OIL DRAIN VALVE 3/8	ALL		63 D7061	HEX NUT 3/8 BRASS-REMOTE UNLOADER	SS32004HG,SS38004VG,SS40004VC	
5 HSS17	SS EXHAUST/FUEL TANK SHIELD	SS30003HG,SS32004HG		64 DC568	STREET ELL 3/8 STEEL	SS32004HG,SS38004VG,SS40004VC	
HSS05	VAN MUFF/HEAT SHIELD LEFT #1	SS38004VG,SS40004VC		65 DH026	HOSE 3/8 x 30in 5000psi NO WIP	SS32004HG,SS38004VG,SS40004VC	
6 PG303	PUMP 3@3500 W/UNL/INJ 1 GAS "	SS30003HG		66 DH003	HOSE 3/8 x 18in 5000psi	SS30003HG	
PG404	PUMP 4@4000: GENERAL 1 DD	SS32004HG,SS38004VG		DH032	HOSE 3/8 x 30in 5000psi NO WIP	SS32004HG,SS38004VG,SS40004VC	
P4060	PUMP 66DX40G11 4000 @ 4 SHAFT	SS40004VC		67 HB100	BATTERY BOX ATTWOOD G24 (LARGE)	ALL	
7 DE866	SWIVEL 3/8F x 3/8M 90	SS32004HG,SS38004VG,SS40004VC		68 HB025	LARGE BATTERY BOX TRAY	SS38004VG	
8 D6588	STREET TEE 1/2 BRASS	SS30003HG,SS32004HG,SS38004VG,SS40004VC		69 WT07R	FUEL TANK 7.5 GAS RED	SS38004VG,SS40004VC	
9 D5588	ELBOW, STREET 1/2 BRASS "	SS32004HG,SS38004VG,SS40004VC		70 WT081	FUEL CAP: GASOLINE	SS38004VG,SS40004VC	
10 D8088	HOSE BARB 1/2 BRASS	SS30003HG,SS40004VC		71 DFF04	FUEL TANK BUSHING 1/4	ALL	
11 D009M	GARDEN H A 3in LONG 1/2 NPT	SS30003HG,SS40004VC		72 DF599	FUEL TANK ADAPTER W/PLASTIC TUBE	SS38004VG,SS40004VC	
12 D0021	SCREEN WASHER GARDEN H A	ALL		73 WT075	FUEL TANK 7.5 DIESEL CLEAR*	ALL	
13 D8044	BARB, HOSE 1/4 BRASS "	SS40004VC		74 WT080	FUEL CAP: DIESEL	ALL	
14 D2088	NIPPLE 1/2 BRASS	SS32004HG,SS38004VG		75 DFE04	FUEL TANK ELL 1/4	ALL	
15 D008F	GARDEN H A 1/2 NPT FEM	SS32004HG,SS38004VG		76 HSS12	SS CONTROL PANEL-SS32004HH 37186	SS30003HG,SS32004HG	
16 DE766	SWIVEL 3/8F x 90 STEEL	SS30003HG		HSS03	SS PROLINECON PANEL NO RADIUS LABEL HYDRO TEK 34 x 3*** HOT	SS38004VG,SS40004VC	
17 D1040	PLUG 1/4 BRASS	SS30003HG		78 GLL79	MOBILE SKID	ALL	
18 UPT46	THERM DUMP VALVE 145f 1/2MPT	ALL		79 GLL10	LABEL GASOLINE ONLY	ALL	
19 DA064	BUSHING 3/8 x 1/4 STEEL	SS30003HG		80 GLL20	LABEL DIESEL FUEL ONLY	ALL	
20 DC043	STREET ELL 1/4, STEEL	SS30003HG		81 HLB09	GROMET NOZZLE HOLDER***	ALL	
21 VS030	PRESSURE SWITCH 4000 1/4 PR16 "	ALL	\$104	82 NQ350	NOZZLE/QDC 035 x 0	SS30003HG	
22 DEB66	BRANCH TEE 3/8 STEEL	SS40004VC		NQ450	NOZZLE/QDC 045 x 0	SS32004HG	
23 VA010	EZ START VALVE	SS40004VC		NQ400	NOZZLE/QDC 04 x 0	SS38004VG,SS40004VC	
24 UP045	PRESSURE RELIEF 4500+15% 500q HONDA VOLTAGE REGULATOR GX270	SS40004VC	\$45	83 NQ352	NOZZLE/QDC 035 x 15	SS30003HG	
25 MH225	COIL CAP (FLAT END COIL) NO HOLE	SS30003HG,SS32004HG		NQ452	NOZZLE/QDC 045 x 15	SS32004HG	
26 B0029	INSUL BLKT 50sq' 1/2 x 24 # 25'	ALL		NQ402	NOZZLE/QDC 04 x 15	SS38004VG,SS40004VC	
27 BN053	INSUL DISC RETAINER 17.5DIA	ALL		84 NQ253	NOZZLE/QDC 025 x 25	SS30003HG	
28 BN125	INSUL DISC RETAINER 17.5DIA	ALL		NQ353	NOZZLE/QDC 035 x 25	SS32004HG	
29 B0089	COIL WRAP (FLAT END COIL) TOP	ALL		NQ303	NOZZLE/QDC 03 x 25	SS38004VG,SS40004VC	
30 BC480	COIL, 4PK SCH 80	ALL		85 NQ970	NOZZLE/QDC 40.0 x 65	ALL	
31 B0088	COIL WRAP (FLAT END COIL) BOTTOM	ALL		86 EC405	ROCKER SWITCH CLR 12V 20A DPST	ALL	
32 BN126	INSUL DISC RETAINER 17.5 DIA. W/ HOLE	ALL		87 ECH72	KNOB: RED .25 x 1.50od	ALL	
33 B0017	END CAP (FLAT END COIL) 18in BURNER	ALL		88 ECH50	THERMASTAT: 60-260 1 GP PART=25 TANK, FLOAT 4 GAL HD LINEAR (NO HOLES)	ALL	\$105
34 BC850	BURNER NIPPLE: 1/2 x 5 SCH80	ALL		89 WT040	FLOAT VALVE 3/8 BRASS	OPTIONAL FOR SS40004VC	
35 BC225	COIL ASM 4PK (FLAT END COIL)	ALL		90 VVFO8	TANK CAP 4in W/HOLE	OPTIONAL FOR SS40004VC	
36 HHP15	BURNER RAINGUARD-HP-2004	ALL		91 HL017	STREET ELL 3/8 BRASS	OPTIONAL FOR SS40004VC	
37 B2324	COIL NIPPLE RETAINER 1/2in	ALL		92 D5566	PANEL FITTING 3/4 BRASS	OPTIONAL FOR SS40004VC	
38 DE586	STREET ELL 1/2F x 3/8M STEEL	ALL		93 D7520	FLOAT TANK WASHER 1.75od 14GA SS	OPTIONAL FOR SS40004VC	
39 DE066	TEE 3/8 STEEL	SS32004HG,SS38004VG,SS40004VC		94 FW701	SPRING GARDEN H A	OPTIONAL FOR SS40004VC	
40 UP137	PRESSURE RELIEF 3700psi black	SS30003HG,SS32004HG		95 D0010	GARDEN H A 3/8 NPT MALE	OPTIONAL FOR SS40004VC	
UP045	PRESSURE RELIEF 4500+15% 500q	SS38004VG,SS40004VC		96 D006M	SCREEN WASHER GARDEN H A	OPTIONAL FOR SS40004VC	
41 VS005	FLOW SWITCH 8 @ 4200 ST5	SS30003HG		97 D0021	WATER TANK BUSHING	OPTIONAL FOR SS40004VC	
42 DEB66	BRANCH TEE 3/8 STEEL	SS30003HG		98 DFF10	STRAINER TUBE FOR FLOAT TANK	OPTIONAL FOR SS40004VC	
43 HHA00	HEX MANI OUTLET 1/2 x 1/2 NO REEL	ALL		100 D1010	SPLICER 5/8 BRASS	OPTIONAL FOR SS40004VC	
44 ECH75	HEAVY DUTY BEND RESTRICTOR -B	ALL		101 HSS20	FLOAT TANK SPACER (SS SERIES)	OPTIONAL FOR SS40004VC	
45 UPB05	ADAPTER FITING-BURST DISC***	ALL		102 WT046	FLOAT TANK ASM W/VALVE/FILTER	OPTIONAL FOR SS40004VC	
46 UPB80	BURST DISC 8000psi TORQUE 32-4	ALL		103 VG200	TRIGGER GUN, INSULATED 4000psi	ALL	
47 DE568	SWIVEL 3/8F x 1/2M STEEL	ALL		104 DQ74T	M22 TWIST COUPLER 1/4 MALE "	ALL	
48 BZ175	FUEL NOZZLE 1.75 80B	SS30003HG		105 DQ74F	TWIST COUPLER 1/4 PLUG FEM-sut "	ALL	
BZ225	FUEL NOZZLE 2.25 80B	SS32004HG,SS38004VG		106 HNZ05	NOZZLE HOLDER (FOR WAND)	ALL	
BZ226	FUEL NOZZLE 2.25 80A	SS40004VC		107 HLB30	GROMET; WAND 1 "	ALL	
49 ECC07	RELAY: BURNER 12V DC (CAN TYPE)	ALL		108 VW045	WAND 1/4 x 48in MOLDED GRIP	ALL	
50 EWC08	STRAIN RELIEF 1/2 HEYCO (3/8)	ALL		109 DQ04S	COUPLER 1/4 SOCK FEM	ALL	
51 BU013	BURNER: BECKET 12V W/SUPPORT	ALL		110 AVGH3	WAND ASSEM 48 MOLDED GRIP W/ NOZZLE HOLDER "	ALL	
52 D8044	BARB: HOSE 1/4 BRASS* .312 t	ALL		111 DH050	HOSE 3/8 x 50' 3000psi 250f BL		
53 BF015	FUEL FILTER: INLINE	ALL		DH057	HOSE 3/8 x 50' 4000psi 250f re		
54 UU370	UNLOADER 2-4 @ 3200 K7-0	SS32004HG	\$328	ABMAG	OPERATION PACKET GENERAL PRO		
UU323	UNLOADER 4350si 8GPM AR	SS38004VG,SS40004VC	\$188				