

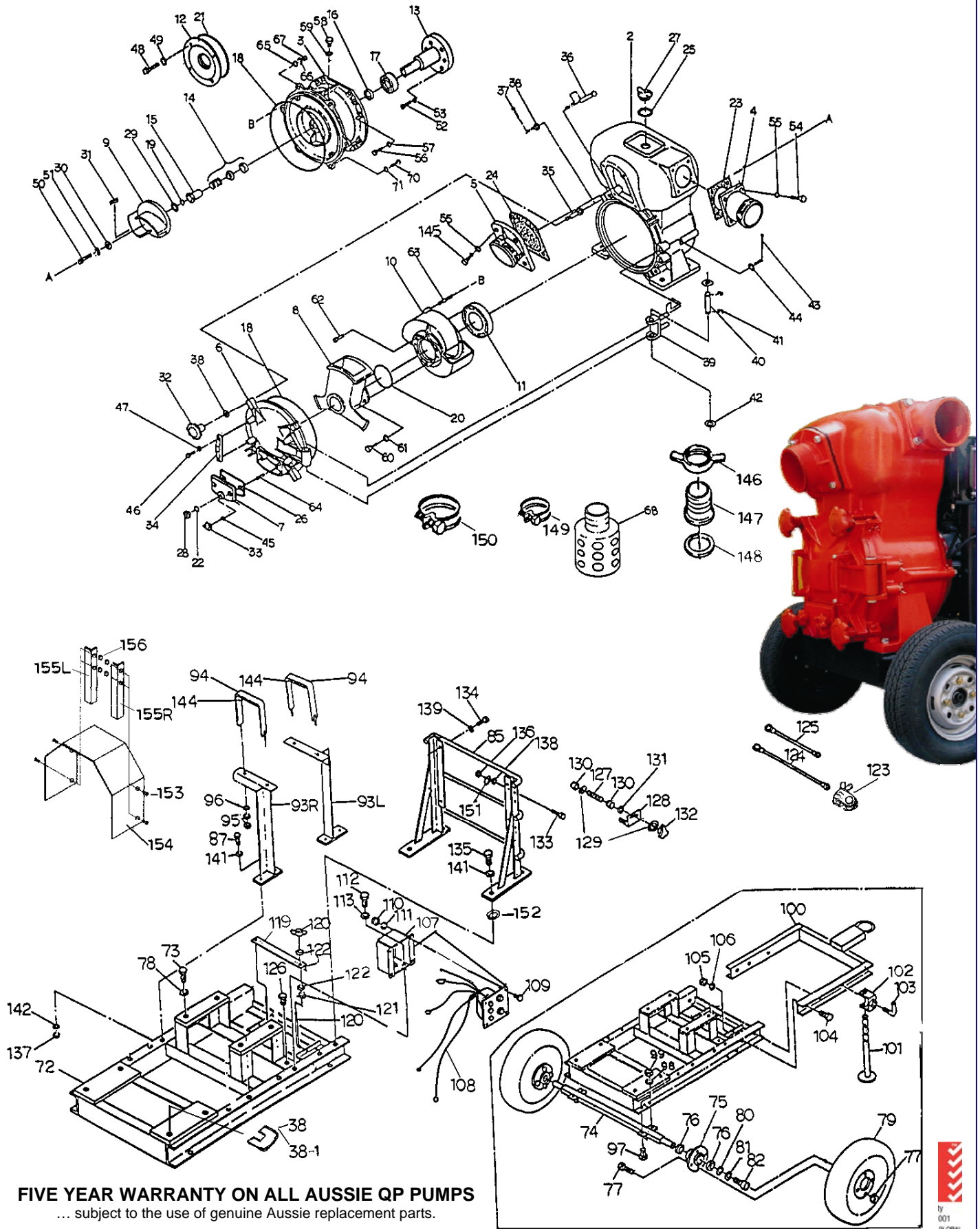

AUSSIE SPARES DIAGRAM & PARTS LIST

AUSSIE QP TRANSFER PUMPS: QP60TD



**FIVE YEAR WARRANTY ON ALL AUSSIE QP PUMPS**  
 ... subject to the use of genuine Aussie replacement parts.





## AUSSIE SPARES DIAGRAM & PARTS LIST

### AUSSIE QP TRANSFER PUMPS: QP60TD

Position	Part number	Description	Qty
	S3L31MJXX	ENGINE	1
2	2601-000010-0001	CASING	1
3	2620-000023-0001	CASING COVER	1
4	4601-000090-0001	DELIVERY COVER	1
5	4601-000160-0001	SUCTION COVER	1
6	2608-000170-0001	DRAIN COVER	1
7	2601-000210-0001	DRAIN COVER-B	1
8	2601-000800	SUCTION CASE	1
9	2602-000032	IMPELLER	1
10	2620-000130	VOLUTE CASING	1
11	4607-000700	WEAR PLATE	1
12	4607-000750	MECHANICAL SEAL HOUSING	1
13	2632-221010	PUMP SHAFT	1
14	080133-4545	MECHANICAL SEAL	1
15	081138-4576	MECHANICAL SEAL SLEEVE	1
16	086245-6209	OIL SEAL	1
17	067002-6209	BALL BEARING	1
18	048360-4300	O-RING (CASING. DRAIN COVER)	2
19	048035-0380	O-RING (MECHANICAL SEAL SLEEVE)	1
20	048057-1400	O-RING (VOLUTE CASING)	1
21	048220-1000	O-RING (MECHANICAL SEAL HOUSING)	1
22	048035-0300	O-RING (DRAIN CAP)	1
23	1601-330360	PACKING (DELIVERY COVER)	1
24	1601-350350	CHECK VALVE	1
25	074132-0503	PACKING (FLOODING CAP)	1
26	1601-330380	PACKING (DRAIN COVER-B)	1
27	063121-1202-0002	FLOODING CAP	1
28	063121-1100ASSY	DRAIN CAP WITH O-RING	1
29	085285-6439	ADJUST LINER	3
30	4607-201240-0011	IMPELLER WASHER	1
31	051108-1054	KEY	1
32	2601-000190-0001	DRAIN COVER SET HANDLE	4
33	2601-000220-0001	DRAIN COVER SET-B SET HANDLE	2
34	1247-100250-0001	DRAIN COVER HANDLE	2
35	2601-200270-0001	HINGE BOLT	4
36	2601-200280-0001	HINGE PIN	4
37	064140-0430	SPLIT PIN	4
38	085283-0000	BASE LINER	4
38-1	085285-0000	BASE LINER	4
39	2601-200260-0001	DRAIN COVER SET HINGE	1
40	2601-200300-0001	HINGE SET PIN	1
41	046272-1915	E-RING	2
42	040145-0200	WASHER	2
43	064230-0528	SPLIT PIN	2
44	040145-0160	WASHER	12
45	040145-0120	WASHER	2
46	014105-0825	SCREW (DRAIN COVER HANDLE)	4
47	045125-0080	SPRING WASHER	4
48	010509-0820	BOLT (MECHANICAL SEAL HOUSING)	4
49	045129-0080	SPRING WASHER	4
50	010509-1225	BOLT (IMPELLER)	1
51	045129-0120	SPRING WASHER	1
52	010505-1235	BOLT	3
54	010505-1645	BOLT (SUCTION COVER. DELIVERY COVER)	4
55	045125-0160	SPRING WASHER	8
56	010705-1030	BOLT (CASING COVER)	8
57	045125-0100	SPRING WASHER	8
58	010505-2030-0001	BOLT (OIL CAP)	3
59	4607-287110	OIL CAP WASHER	3
60	010509-1030	BOLT (SUCTION CASE)	2
61	045129-0100	SPRING WASHER	2
62	013119-1020	CAP SCREW (WEAR PLATE)	3
63	015116-1035	STUD BOLT (VOLUTE CASING)	2
64	015115-1230	STUD BOLT (DRAIN COVER-B)	2
65	045822-0100	SEAL WASHER	2
66	045125-0100	SPRING WASHER	2
67	020445-0100	U-NUT	2
68	074221-1150	STRAINER	1
70	010505-1655	BOLT	10
71	045125-0160	SPRING WASHER	10
72	2632-214010-0005	BASE	1
73	010505-1230	BOLT	4

Position	Part number	Description	Qty
74	2629-219040-0005	AXLE WITH TRAY	1
(74-1)	(2629-219040)	(AXLE TRAY)	
75	2620-219101-0005	WHEEL	2
76	067006-6206	BALL BEARING	4
77	2629-209170	BOLT SET	8
78	045125-0120	SPRING WASHER	4
79	098500-1061	TIRE	2
80	2629-209160	WASHER	4
81	045125-0180	SPRING WASHER	2
82	013115-1825	CAP SCREW	2
85	2632-214210-0005	RADIATOR BASE	1
87	010505-1025	BOLT	4
93R	2632-214101-0005	FUEL TANK BASE	1
93L	2632-214111-0005	FUEL TANK BASE	1
94	2632-214130-0005	FUEL TANK BAND	2
95	020545-0080	NUT	8
96	045125-0080	SPRING WASHER	4
97	010505-1225	BOLT	4
98	045125-0120	SPRING WASHER	4
99	020545-0120	NUT	4
100	2629-219050-0005	DRAWING BAR	1
101	2629-219070-0005	STAND	1
102	2629-219080-0005	STAND HOLDER	1
103	2611-209090-0005	STAND HANDLE	1
104	010505-1830	BOLT	4
105	020545-0180	NUT	4
106	045125-0180	SPRING WASHER	4
107	2629-219240-0005	CONTROL BOX	1
108	2632-996800	HARNES (ENGINE)	1
109	010505-0610	BOLT	4
110	020545-0060	NUT	4
111	045125-0060	SPRING WASHER	4
112	010505-0810	BOLT	2
113	045125-0080	SPRING WASHER	2
119	095021-1240-0005	BATTERY SET PLATE	1
120	095021-1240A	BOLT WITH NUT	2
121	020545-0060	NUT	2
122	045125-0060	SPRING WASHER	2
123	096903-3000	TERMINAL SET	1set
124	097209-9900	CORD(+)	1
125	097209-9300	CORD(-)	1
126	010505-0810	BOLT	1
127	017116-0630	THROTTLE BOLT	1
128	2632-219250-0005	CONTROL PANEL	1
129	040145-0060	WASHER	3
130	020445-0060	U-NUT	2
131	020545-0060	NUT	1
132	2629-992910	KNOB NUT	1
133	010505-0816	BOLT	2
134	010505-0816	BOLT	4
135	010505-1025	BOLT	4
136	020545-0080	NUT	2
137	020545-0100	NUT	4
138	045125-0080	SPRING WASHER	2
139	045125-0080	SPRING WASHER	4
141	045125-0100	SPRING WASHER	8
142	045125-0100	SPRING WASHER	4
144	2634-434270	TANK BAND PACKING	2
145	010505-1655	BOLT (SUCTION COVER)	4
146	074111-0150	HOSE COUPLING	2
147	074124-0150	HOSE JOINT	2
148	074132-1501	HOSE COUPLING PACKING	2
149	093225-0160	WIRE HOSE BAND	1
150	093225-6000	WIRE HOSE BAND	2
151	040145-0080	WASHER	4
152	040145-0100	WASHER	4
153	018105-0820	BOLT SET WITH SPRING WASHER	4
		WATERPROOF COVER WITH DITCH	
154	2632-214490-0005	RUBBER	1
(154-1)	(1471-338510)	(DITCH RUBBER)	(2)
155R	2632-204480-0005	WATERPROOF COVER STAY	1
155L	2632-204470-0005	WATERPROOF COVER STAY	1
156	020915-0080	FLANGE NUT	1



RELIABLE PRODUCTS ... RELIABLE PEOPLE